

# Hand Tubing Cutters (HTC)

HTC 500 | 408, HTC 500 | 418

Recommended for cutting rigid plastic tubing

## Benefits

- Sharp blade for clean cuts
- Durable nylon construction for long life
- Patented design
- Made in USA



Hand Tubing Cutter  
HTC 500 | 408  
Item No. 14100408



Radial Hand Tubing Cutter  
HTC 500 | 418  
Item No. 14100418

### HTC 500 | 408

Smooth scissor action cuts in limited access applications

V-shaped nest prevents tube from rolling during cutting

Curved, ergonomic handles fit palm regardless of hand size

Durable chemically resistant glass-filled nylon

### HTC 500 | 418

Fits in tight spaces – only 4 1/4" long

Provides correct cutting pressure for a square cut with 1 1/2 to 2 rotations – eliminates need to deburr

Automatically adjusts to tube diameter

Compact size easily fits in tool belt or pocket



TECHNICAL DATA OVERVIEW

**Hand Tubing Cutter**

Model No.	HTC 500   408
Item No.	14100408
Max. jaw opening	25.0 mm
Jaw width	24.0 mm
Length	165.0 mm
Height	58.0 mm
Weight	136.0 g

**Radial Hand Tubing Cutter**

Model No.	HTC 500   418
Item No.	14100418
Max. jaw opening	30.0 mm
Jaw width	32.0 mm
Length	109.0 mm
Height	22.0 mm
Weight	68.0 g

APPLICATIONS

**HTC 500 | 408\***

Cuts up to 22.0 mm (0.875") OD of the following types of pipe, tubing and hose:

- PEX tube up to 3/4", type A, B, & C
- HDPE gas pipe
- Polyester braid reinforced
- Silicone rubber
- Nitrile air hose
- Thermoplastic

**HTC 500 | 418\***

Cuts these types and sizes of pipe and tubing:

- PEX tubing: 1/2" to 1" PEX tube type A, B & C
- MRO pipe:
  - MDPE gas pipe:
    - 1/2" & 3/4" CTS
    - 1/2", 3/4" & 1" IPS
  - Conduit:
    - SDR9, SDR11, SDR13.5, SDR15.5, SDR17, SCH40
    - 1/2" & 3/4" Flex Plus Blue

\*Not for use on PVC or CPVC pipe

INSTRUCTION GUIDE

HTC 500 | 408

HTC 500 | 418

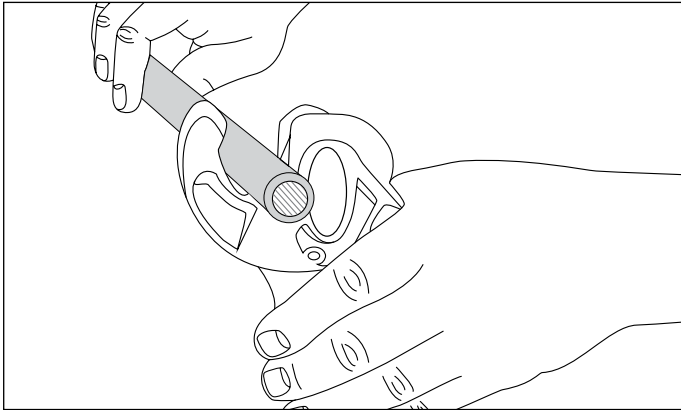

1. Place cutting chamber around tube.

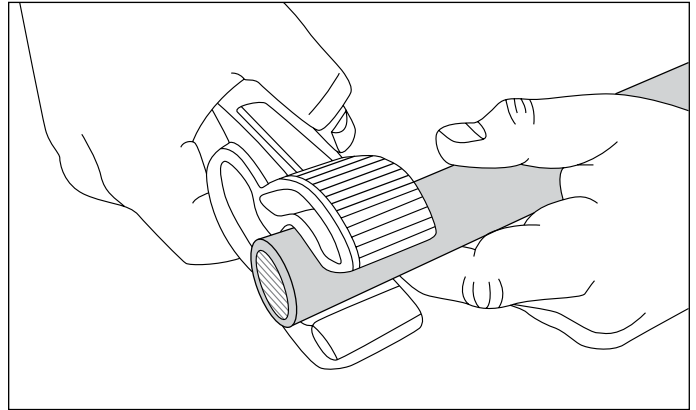

1. Push pipe into cutting chamber.

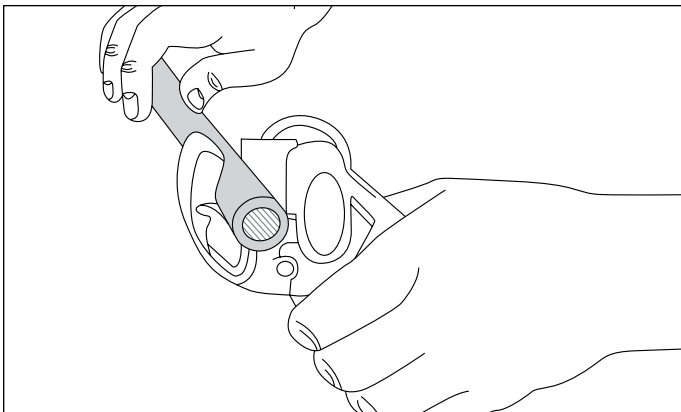

2. Squeeze handles.

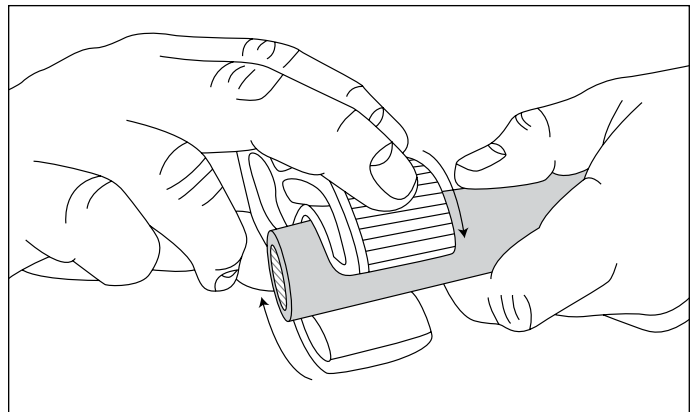

2. Rotate cutter in direction of arrow.

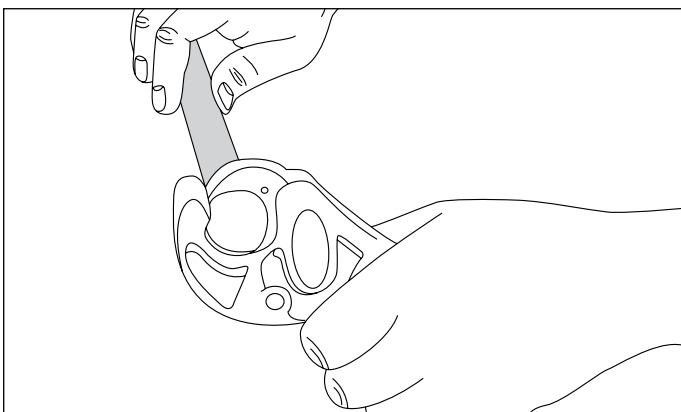

3. Remove pipe.

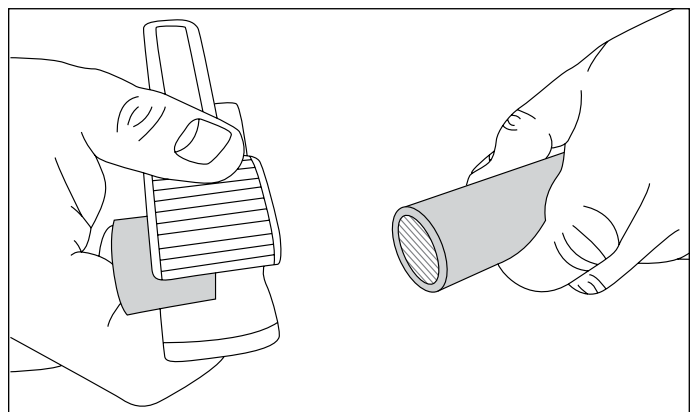

3. Squeeze handles and remove pipe.