

# Locking Assurance Cap System

## 201 & 210 Quick Connectors



Recommended for Engine Oil Cooling, Transmission Oil Cooling, Turbocharger Cooling and Oil Supply and Electric Vehicle Cooling Applications

### Benefits

- Instant connection verification
- Ergonomic design
- Maximum durability and retention
- Quick cycle and installation time

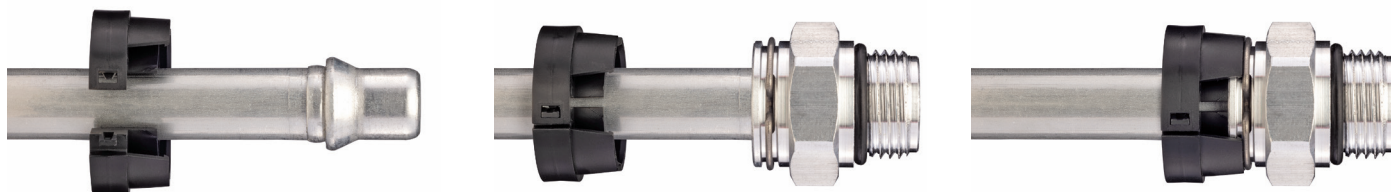

### PRODUCT DESCRIPTION

The Locking Assurance Cap system serves as a device to provide 100% confidence the tube is fully seated into the quick connector and features a durable secondary latch.

### ADVANTAGES

#### Assembler

- Tactile and audible feedback ensures the connection has been made
- Low installation and insertion force
- Eliminates false positive connections and secondary verification operations
- Black, natural, and gray color options available for identification

#### Tier

- Installed after tube forming operation
- Durable latch and hinge mechanism
- Reliable and secure
- Easy installation on tube line set
- Controlled tight inner diameter allows Locking Assurance Cap to remain securely in place on tube

## FEATURES

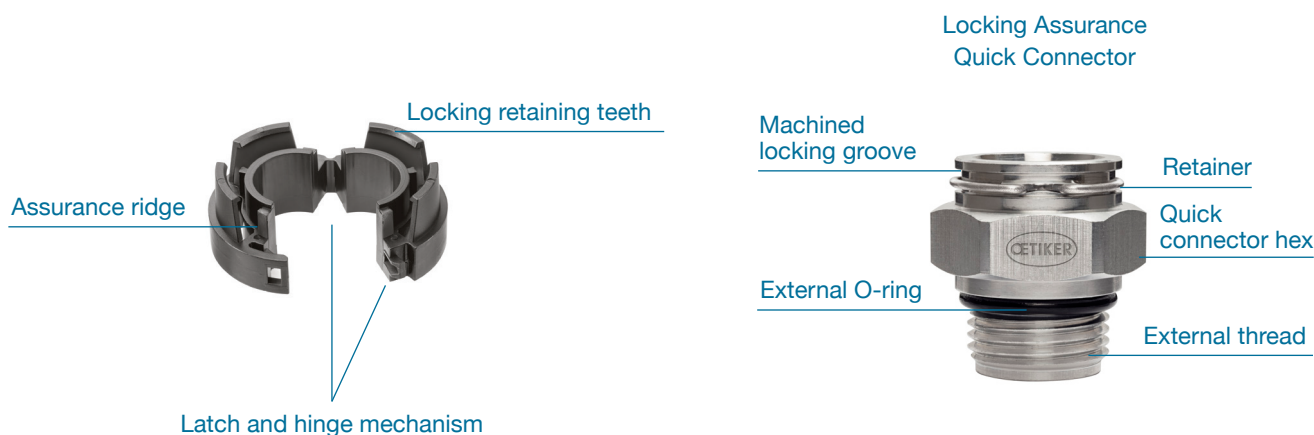

**Assurance Ridge:** Prevents installation to unassembled quick connector and tube interface

**Robust Latch and Hinge Mechanism:** Easy and reliable installation over tube

**Nylon Polyamide Material:** Inherent corrosion and temperature resistance and lightweight material

**Machined Locking Groove:** Seats and holds retaining teeth for secondary latch mechanism

## TECHNICAL DATA - LOCKING ASSURANCE CAP

### Overall Locking Assurance Cap dimensions

Line size (in)	Diameter	Height	Installed height with QC
3/8"	22mm	13.31mm	21.28mm
1/2"	27mm	13.54mm	26.19mm

- Locking Assurance Cap is designed to fit imperial sized tubes

See Oetiker Connection verification Design Guide for further details on packaging space recommend

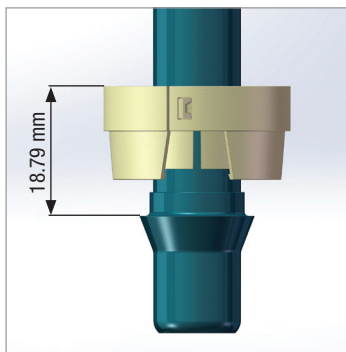

## TECHNICAL DATA - LOCKING ASSURANCE QUICK CONNECTOR

### Overall Locking Assurance Cap dimensions

Line size (in)	Hex size	Ext thread size	Overall length	Installed height
3/8"	20.33mm	9/16-18 UNF-2A	24.40mm	9.81mm
1/2"	25.4mm	3/4-16 UNF-2A	28.40mm	14.84mm

- Locking Assurance Quick Connector has the same performance and material options as standard 201 & 210.
- Locking Assurance Quick Connector can also accept standard assurance cap.

## ASSEMBLY

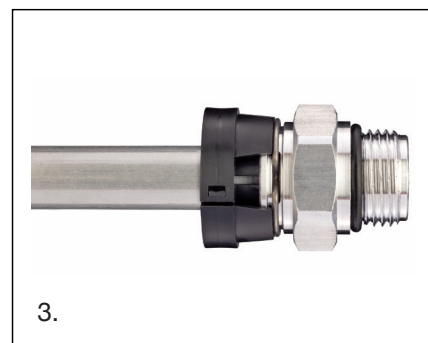
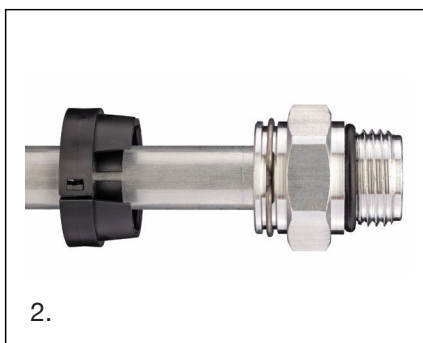
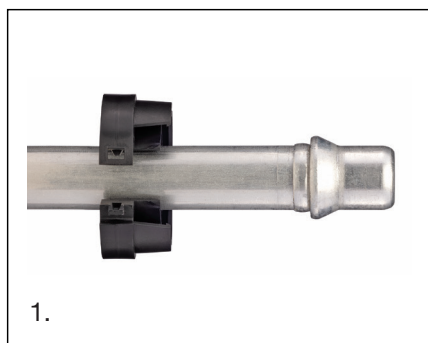

1. Place Locking Assurance Cap over the tube near the end form with the Retaining Teeth pointing towards end form.
2. Secure Locking Assurance Cap onto the tube by snapping the latch mechanism together. Insert tube fully into Quick Connector using the recommended Oetiker Connector Assembly Instructions (08905017).
3. Install Locking Assurance Cap onto the Quick Connector and the retaining teeth will “snap” into place. Firmly pull back on Locking Assurance Cap. The Locking Assurance Cap will not install onto quick connector unless the tube is fully inserted into the quick connector, thereby assuring the connection has been made.

**Note: The Locking Assurance Cap is not reusable. Disassembling Cap results in deforming or breaking of the component.**

## PERFORMANCE

The Locking Assurance Cap system serves as a device to provide 100% confidence the tube is fully seated into the quick connector and features a durable secondary latch.

### Locking Assurance Cap Latch installation force (Step 2)

Size	Force (N)
3/8"	65N
1/2"	65N

### Locking Assurance Cap Temperature Resistance

Size	Degrees (C)
3/8"	250
1/2"	250

### Locking Assurance Cap installation force onto Quick Connector (Step 3)

Size	Force (N)
3/8"	50N
1/2"	50N